



WhatsGPS

2G Vehicle GPS Tracker

Model:S116mini



User Manual

Technical parameter

- 1). GSM: 850/900/1800/1900MHz
- 2). GPRS: Class12,TCP/IP
- 3). Working Voltage: 9~90V
- 4). Working Current: $\approx 22\text{mA}$ (12vDC)
- 5). Working Current: $\approx 12\text{mA}$ (24vDC)
- 6). GPS Fixed Time: Cold start $\approx 38\text{s}$ (Open sky)
Warm start $\approx 28\text{s}$
Hot start $\approx 2\text{s}$ (Open sky)
- 7). GPS Precision: 10m (2D RM)
- 8). Working Temperature: $-20^{\circ}\text{C}\sim+70^{\circ}\text{C}$
- 9). Working Humidity: 20%~80%RH
- 10).Measurement : L64.5mm*W23.0mm*H12.5mm

Installation

- Please read the instructions in detail;
- Product check, check whether the terminal type is correct, complete accessories?
- Choose SIM card. Please insert a SIM card to the device. Please take dealer's advice as reference.
- SIM card installation. Discharge the cover of the device and uncover the SIM card holder. Then insert the SIM card and cover SIM card holder (as follows).

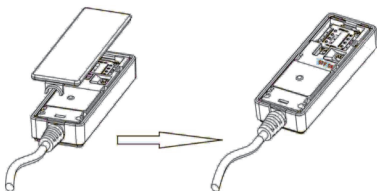

- Switch device must be switched to "ON" when using, as shown.

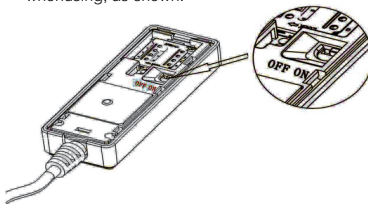

- This time can be connected to the external 9-90V power supply.

Note: because the charging voltage of the electric vehicle is unstable, the instantaneous voltage is too high, and the device is used prudently on the electric vehicle above 70 volts. The vehicle with the following 70V power is the best.

- Finally, the terminal will be fixed in the car's concealed position with two sided glue or tie line.

Note: the terminal SIM card cannot be on backward.

Terminal SIM card needs to open GPRS function, and ensure that the terminal SIM card has tariff. If your SIM is open, you need to input PIN code. Please refer to your mobile phone user manual, and it will turn off the function of input PIN code.

- Terminal location selection and installation This terminal is a high-tech Beidou GPS dual-mode positioning product. It is recommended that you select dealers designated professional units to install and debug. The hidden installation of the terminal is recommended by the professional institution designated by the distributor.

(1)To avoid thieves' destruction, terminal selection should be hidden as much as possible. The concealment of the front windshield underneath the decorative plate; The front dial is hidden around the surface. Underneath the rear windshield;

(2)Avoid being placed with the launch source, such as reversing radar, signal transmitter and other vehicle communication terminals.

(3) The terminal is equipped with GSM antenna and

GPS antenna. When installing, we should ensure that the GPS faces upwards (up to the sky), and there are no metal objects above it.

Note: if the windshield is glued with metal insulation or heating layer, it will reduce the GPS reception signal and cause the GPS work to be out of order. Please change the terminal installation position.

Device connecting requirements.

1. the terminal external power supply is DC 9-90V, the red line is the positive pole of the power supply, and the black line is the negative pole of the power supply.
2. the negative supply select individual ground or ground, not with other ground together.
3. after the power cord is connected, pull the power wiring harness plug to the terminal.
4. concealed installation, the main power supply line provided by the original plant (such as the product parts diagram), the infrared end string(2A FUSE) can play the short circuit over current protection.

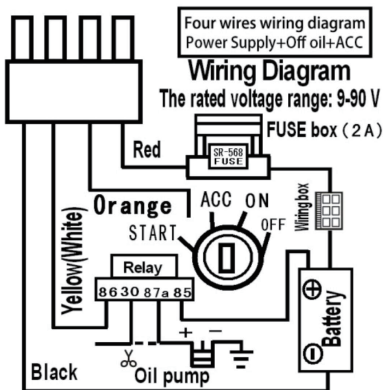
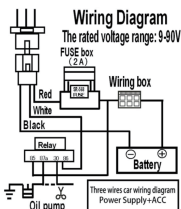
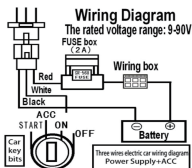

terminal work

- opening: after the terminal is connected to the power, please pay attention to whether the SIM card has been inserted, if the SIM card is not inserted, please dial the switch to the OFF position first, then the external power is disconnected, and then the SIM card is inserted.

After the equipment is opened, the indicator light is opened. When the external power supply connects +GPS to +GSM normal, the indicator light is often bright; when the GPS is normal in +GSM and the outer electricity is not connected, the indicator light is flash; when the GSM is normal + electric connection, and when the GPS is not positioned, the indicator flashes (1.5 seconds, 0.5 seconds open); when the GPS positioning + electric connection is connected, and the GSM network is not normal, the light flashes (3 seconds to flash, 0.5 seconds to open); when the GSM network is abnormal, +GPS is not positioned and the external power is disconnected, the indicator light is not lighted.

- turn off: pull out the power adapter, turn off the device switch, and turn off the power after the terminal is down.

User instruction

1. CENTER

Text command	Parameter	Sample
ADD	CENTER,A,number#	CENTER,A,13500135000#
DEL	CENTER,D#	CENTER,D#
Description	1)center number can be used to send short message instructions to restore the Description factory settings 2)the central number is also the function of SMS and telephone reception.	
Feedback	SET CENTER OK!	

2. 123

Text command	Parameter	Sample
Format	123	123
Description	This command is used to query the current location description	
Feedback	Example:Shenzhen, Guangming,Dayang first road NO.19	

3. VIBRATION

Text command	Parameter	Sample
Format	VIBRATION,level [,alarming way]#	1)VIBRATION,2,3# 2)VIBRATION,2#
Description	The sensitivity value of the vibration is from 1 to 5 1is the most sensitive and o is close. Alarming ways: 1, calling 2, texting, 3 calling and texting. Must set the center number and receiving number.	
Feedback	SET VIBRATION OK!	

4. TIMER

Text command	Parameter	Sample
Format	TIMER,Upload time#	TIMER,30#
Description	1 time range: 10~60 seconds; 2 the default is 10 seconds to upload! 3 timing boot and deep sleep mode has been dormant, upload interval is invalid.	
Feedback	SET TIMER OK!	

5. RESET

Text command	Parameter	Sample
Format	RESET#	RESET#
Description	This instruction is used to restart the device	
Feedback	RESET OK!	

6. RELAY

Text command	Parameter	Sample
Parameter1	RELAY,1#	RELAY,1# cut off oil
Description	1) REL AY control the start and closeness of the relay,in order to control the circle 2) Only the center number can operate. 3) the device only cut off the oil circuit on the condition of the driving speed below 20KM/H and in Positioning state. 4) If it currently do not meet the condition, the device will reply "Do not allow to cut off the oil and power" It declares that the driving speed above 20km/h at this moment ,please try again a little latter.	
Feedback	Relayed enable OK!	

7. PARAM

Command	Parameter	Sample
Format	PARAM#	PARAM#
Description	This instruction is used to query the Description parameters and default parameters set by the device.	
Feedback	IMEI:351190012535936 IMEI APN:cmnet APN IP:www.gps18.com:7700 IP and port CENTER:13800138000 center number TIMER:10S moving uploading interval LANGUAGE:EN language(CN/EN) GMT: E8 time zone(E/W)	

8. FEE

Command	Parameter	Sample
Format	FEE,Query number,contents#	FEE,10010,102# FEE,10086,101#
Description	This instruction is used to query the current calls status of the device SIM card Query number: SIM is the operator of the query number Sample FEE,10010,102# Format Description Content: the contents of the query, such as mobile CXYE is the balance of the query	
Feedback	Return the call query results returned by the operator	

device switch function hints

It is not controlled by the switch of the machine itself. The switch inside is only used to control the battery work. When the device does not connect the electric or external power, it can open the switch and use the battery to work temporarily. So if the power is broken, the switch should be switched to "ON" when the device is installed.

platform site location query

If you have login account information in the platform, you can go directly to the platform service site. Otherwise, please contact your dealer, open the online login account for you, and provide the login

name and password.

Enter the service platform web site in your computer browser address bar, fill in the access account number and password, and then point to the service platform.

Service platform function use operation please get "service platform operation guide" to your dealer.

Trouble shooting

The device is not online or offline on the web platform

First, please check whether the three indicator is normal or not ,if there' s no condition for observe, Please use the cell phone to call the terminal SIM card number, according to the reminding tone to determine the status of the terminal.

If not connected, Indicating that the terminal temporarily can not connect or the GSM signals cannot reach your location Terminal area may not be covered by the GSM signal or weak signal in the basement and other places, please drive to the open sky. If not connected, suggesting that the Terminal is insufficient Or has been shut down

If reminding the device SIM card is out of deposit,

3. VIBRATION

Text command	Parameter	Sample
Format	VIBRATION,level [,alarming way]#	1)VIBRATION,2,3# 2)VIBRATION,2#
Description	The sensitivity value of the vibration is from 1 to 5 1is the most sensitive and o is close. Alarming ways: 1, calling 2, texting, 3 calling and texting. Must set the center number and receiving number.	
Feedback	SET VIBRATION OK!	

4. TIMER

Text command	Parameter	Sample
Format	TIMER,Upload time#	TIMER,30#
Description	1 time range: 10~60 seconds; 2 the default is 10 seconds to upload! 3 timing boot and deep sleep mode has been dormant, upload interval is invalid.	
Feedback	SET TIMER OK!	

5. RESET

Text command	Parameter	Sample
Format	RESET#	RESET#
Description	This instruction is used to restart the device	
Feedback	RESET OK!	

6. RELAY

Text command	Parameter	Sample
Parameter1	RELAY,1#	RELAY,1# cut off oil
Description	1) REL AY control the start and closeness of the relay,in order to control the circle 2) Only the center number can operate. 3) the device only cut off the oil circuit on the condition of the driving speed below 20KM/H and in Positioning state. 4) If it currently do not meet the condition, the device will reply "Do not allow to cut off the oil and power" It declares that the driving speed above 20km/h at this moment ,please try again a little latter.	
Feedback	Relayed enable OK!	

7. PARAM

Command	Parameter	Sample
Format	PARAM#	PARAM#
Description	This instruction is used to query the Description parameters and default parameters set by the device.	
Feedback	IMEI:351190012535936 IMEI APN:cmnet APN IP:www.gps18.com:7700 IP and port CENTER:13800138000 center number TIMER:10S moving uploading interval LANGUAGE:EN language(CN/EN) GMT: E8 time zone(E/W)	

8. FEE

Command	Parameter	Sample
Format	FEE,Query number,contents#	FEE,10010,102# FEE,10086,101#
Description	This instruction is used to query the current calls status of the device SIM card Query number: SIM is the operator of the query number Sample FEE,10010,102# Format Description Content: the contents of the query, such as mobile CXYE is the balance of the query	
Feedback	Return the call query results returned by the operator	

device switch function hints

It is not controlled by the switch of the machine itself. The switch inside is only used to control the battery work. When the device does not connect the electric or external power, it can open the switch and use the battery to work temporarily. So if the power is broken, the switch should be switched to "ON" when the device is installed.

platform site location query

If you have login account information in the platform, you can go directly to the platform service site. Otherwise, please contact your dealer, open the online login account for you, and provide the login

name and password.

Enter the service platform web site in your computer browser address bar, fill in the access account number and password, and then point to the service platform.

Service platform function use operation please get "service platform operation guide" to your dealer.

Trouble shooting

The device is not online or offline on the web platform

First, please check whether the three indicator is normal or not ,if there' s no condition for observe, Please use the cell phone to call the terminal SIM card number, according to the reminding tone to determine the status of the terminal.

If not connected, Indicating that the terminal temporarily can not connect or the GSM signals cannot reach your location Terminal area may not be covered by the GSM signal or weak signal in the basement and other places, please drive to the open sky. If not connected, suggesting that the Terminal is insufficient Or has been shut down

If reminding the device SIM card is out of deposit,

please recharge it.If you can connect to the device when calling,and hear a beep. Du, du. noise the SIM card is installed correctly and has deposited and please check with your operator for GPRS function. You also can check by searching the internet on your mobile phone. If you can not open website ,the GPRS function has not open .please contact with the operator to open

If the terminal is not connected and reminding shutdown

GPRS Tips

SIM card GPRS data suggested a monthly subscription service using GPRS If the vehicle moving for a long time every day, please change the upload interval longer, for example: TIMER,30#

Warranty card

Maintenance record	
Maintenance shop	
Sending date	
Fault description	
Maintenance situation	
IMEI number	
Maintenance person	

Maintenance record	
Maintenance shop	
Sending date	
Fault description	
Maintenance situation	
IMEI number	
Maintenance person	